

2. Surface

Contemporary Surface Square

S24H



DIMENSIONS

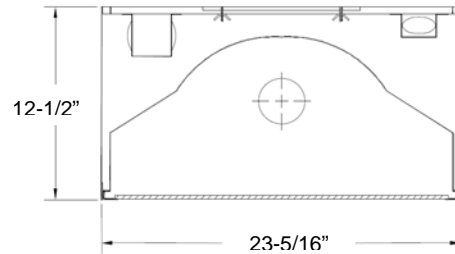

Dimensions are subject to change. For critical applications, verify all dimensions with factory.



ORDERING

Available in mogul base lamping, Pulse Start Metal Halide and High Pressure Sodium up to 400W. Full compliment of lens and louver shielding media to suit most lighting needs. Completely prewired and assembled with removable ballast assembly. Designed for surface mount applications. Consult factory for other ceiling installations custom mounting brackets available if required. Automatic resetting heat sensitive thermal protection device will protect fixture from overheating if insulation covers fixture. Cold rolled steel doorframe with captive countersunk ¼ turn spring loaded fasteners and concealed stainless steel hinging. Stainless steel doorframes are also available.

HOUSING

20 gauge CRS welded construction. Aluminum or stainless steel housing available.

ELECTRICAL

Metal Halide 100W and High Pressure Sodium 100W-150W. High reactance autotransformer, High Power Factor, encased and potted, auto resetting type. Metal Halide 175W-400W and High pressure Sodium 250W and 400 CWA High Power Factor, encased, potted and auto-resetting type.

REFLECTOR

Aluminum painted white, one piece, .030" thick.

FINISH

Detergent cleaned with iron phosphate and chromic acid rust inhibitor, chip resistant, powder urethane polyester coating, electrostatically applied and baked.

CERTIFICATION

All units bear UL and Made in U.S.A. label. UL Listed for damp location.

MODEL	WATTAGE	TYPE	VOLTAGE
S24H	150	PSMH -	120
	175	Pulse Start	277
	200	Metal Halide	480
	250		MULTI
	320		
	350		
	400		
	450		
	150	HPS -	
	250	High	
	400	Pressure Sodium	

OPTIONS

- SST** – Stainless Steel Housing
- ALUM** – Aluminum Housing
- SST** – Stainless Steel Trim
- TP** – Tamperproof hardware
- GLR** – Single Fuse
- QZ** – Quartz Restrike
- TG** – Tempered Glass Prismatic
- RG** – Regressed Prismatic Glass Lens
- AD** – Acrylic Prismatic Drop Lens
- PD** – Polycarbonate Prismatic Drop Lens
- PL** – Prismatic Glass Lens & ½ inch Parabolic Louver
- PL9** – Prismatic Glass Lens & 9 Cell Parabolic Louver
- PL16** – Prismatic Glass Lens and 16 Cell Parabolic Louver
- FLG** – Flanged Housing (Gypsum Board Ceiling)
- EPC** – Epoxy filled core and coil ballast

JOB NAME:

FIXTURE TYPE:

MODEL NO:

