

2. Surface

Extruded Aluminum Cylinder

S60/S80



DIMENSIONS

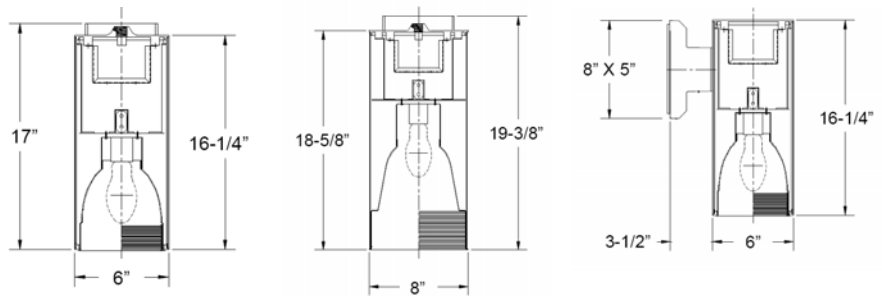

Dimensions are subject to change. For critical applications, verify all dimensions with factory.



ORDERING

Available in Metal Halide and High Pressure Sodium. Available in 6" and 8" diameters. 6" units accommodate lamping up to 70w. 8" units accommodate lamping up to 100w. Surface mounting is standard. Optional stem and canopy mounting hardware include 3/8" I.P.S. 12" stem with 0-45 swivel canopy. Optional wall mounts come as a one-piece cast aluminum arm with access plate.

HOUSING

Heavy gauge extruded aluminum rolled and seam welded.

ELECTRICAL

For metal halide lamping ballast is high power factor, constant wattage auto transformer. For high-pressure sodium, ballast is normal power factor reactor type for 120V. High power factor, multi-tap, and most fixed voltages available.

REFLECTOR

Spun aluminum .040" thick, polished specular alzak.

FINISH

Standard in urethane polyester powder coat bronze. Optional black or white finish is available.

CERTIFICATION

All units bear UL and Made in U.S.A. label. Suitable for damp locations. Optional wet location.

MODEL	WATTAGE	TYPE	VOLTAGE
S60- 6" unit	35	PSMH- Pulse Start Metal Halide	120
	50		277
	70		480
	100A	INC- Incandescent	MULTI
	100PAR38		
	18	CF- Compact Fluorescent	
	26		
	32		
S80- 8" unit	50	PSMH- Pulse Start Metal Halide	
	70		
	100		
	26	HPS- High Pressure Sodium	
	32		
	42		

OPTIONS:

- WL** – Wet Location (For Wall Mount Only)
- EM** – Remote Emergency Battery Back Up (For Compact Fluorescent Only)
- PC** – Photocell
- GLR** – Single Fuse
- QZ** – Quartz Re-strike (For Pulse Start Metal Halide Only)
- ST** – Stem Mount (12" Standard)
- WM** – Wall Mount
- S** – Surface Mount
- CL** – Clear Reflector
- BB** – Black Baffle
- CL/L** – Clear Reflector with Tempered Glass Lens
- BB/L** – Black Baffle with Tempered Glass Lens
- LG** – Louver Guard
- BZ** – Bronze Finish
- BK** – Black Finish
- WH** – White Finish



JOB NAME:

FIXTURE TYPE:

MODEL NO: