

5. Strips & Industrials

Single Lamp Low Profile Strip

ST



DIMENSIONS

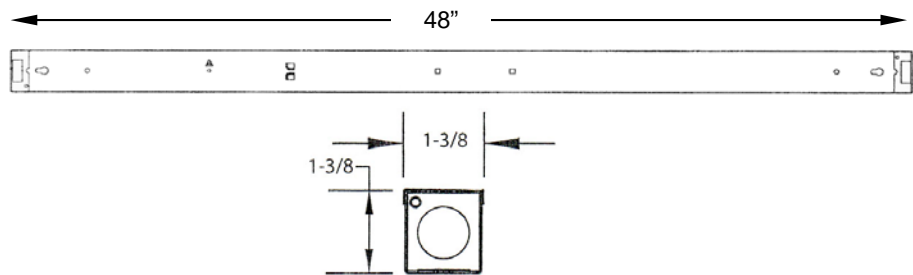

Dimensions are subject to change. For critical applications, verify all dimensions with factory.



Available in nominal 2', 3', 4' lengths in 1-lamp configurations, T5, 13W, 14W, 21W, 28W or T5-HO 24W, 39W and 54W. Fully assembled housing for individual or continuous row mounting. Pre-drilled mounting holes for easy installation. Can be fed through end or back of unit. Suitable for low density ceiling applications. Symmetric, asymmetric, and light shield and swivel adjustable reflectors available. Snap-on diffusers in clear or opal available. Available with energy efficient reflectors in specular silver (95% reflectance) or specular aluminum (85% reflectance).

HOUSING

Die formed heavy gauge steel housing with ample knockouts for ease of installation.

ELECTRICAL

Energy saving electronic ballasts comply with Federal Energy Efficiency standards. Ballasts are <10% THD and include 5 year manufacturer's warranty. Ballasts operate on 120V-277V (UNV) unless specified otherwise.

FINISH

All parts pre-painted with high gloss baked white enamel with minimum 89% reflectance applied over iron phosphate pretreatment for maximum adhesion and rust resistance.

CERTIFICATION

All units bear UL label. Made in U.S.A. Suitable for damp location. ARRA and BAA compliant.

ORDERING

MODEL	LAMP QTY	WATTAGE/TYPE	VOLTAGE
ST	1	4W T5 - (7" length)	120
		6W T5 - (12" length)	277
		8W T5 - (15" length)	UNV
		13W T5 - (21" length)	
		14W T5 - (22 7/16" length)	
		21W T5 - (34 1/4" length)	
		28W T5 - (46" length)	
		54W T5HO - (46" length)	
		15W T8 - (18" length)	
		17W T8 - (24" length)	
		25W T8 - (36" length)	
		32W T8 - (48" length)	

OPTIONS:

- EM - Emergency
- DM - Dimming
- SR - Symmetric Reflector
- AR - Asymmetric Reflector
- LS - Wall Wash Light Shield
- WG - Wire Guard
- CK24 - 24" Chain Kit
- SA95 - High Efficiency Specular Reflector
- SA87 - Specular Reflector
- WH92 - High Efficiency White Reflector



JOB NAME:

FIXTURE TYPE:

MODEL NO: