

4. Outdoor Cut-Off Cast Aluminum Exterior Wall Bracket

CWPA

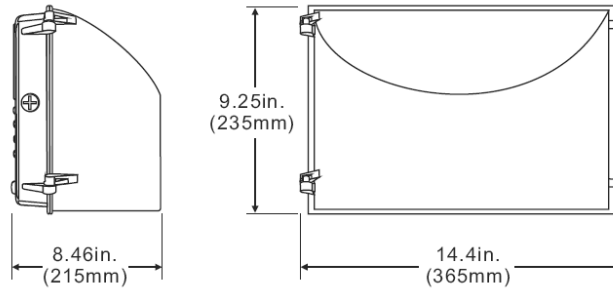

DIMENSIONS



Dimensions are subject to change. For critical applications, verify all dimensions with factory.



ORDERING

Die cast aluminum housing with integral hinging feature for ease of maintenance. Available in high-pressure sodium 70W-150W and metal halide from 70W-175W. 42W compact fluorescent also available. Heat and impact resistant tempered glass is standard. Textured anodized aluminum reflector delivers uniform light distribution. 1/2" threaded apertures are provided for surface conduit installation and/or optional factory installed photocells. Fully gasketed weather resistant construction. Unit mounts directly over standard 4" outlet box or with surface conduit conditions.

HOUSING

Rugged die cast aluminum housing.

ELECTRICAL

For metal halide lamping, ballast is high power factor, constant wattage auto transformer. Electrical components are mounted to cast aluminum housing for optimum heat dissipation. For high pressure sodium, ballast is normal power factor reactor type for 120V. High power factor, multi-tap, and most fixed voltages available.

FINISH

Baked on premium architectural bronze for maximum durability is standard. Custom colors are available upon request.

CERTIFICATION

All units bear UL and Made in U.S.A. labels. Labeled for wet or damp locations.

<u>MODEL</u>	<u>WATTAGE</u>	<u>TYPE</u>	<u>VOLTAGE</u>
CWPA	70	PSMH-	120
	100	Pulse Start	277
	150	Metal Halide	480
			MULTI
	100	HPS-	
	150	High Pressure Sodium	
	70	IND-	
		Induction	
	(1 or 2) 26	CF- Compact	120
	(1 or 2) 32	Fluorescent	277
	(1 or 2) 42		UNV

OPTIONS:

- EM** – 90 Min. Remote Battery Back-Up
- PC** – Photocell
- VS** – Vandal Shield
- TP** – Tamperproof hardware
- GLR** – Fusing
- QZ** – Quartz Restrike
- CC** – Custom Color

JOB NAME:

FIXTURE TYPE:

MODEL NO:

