

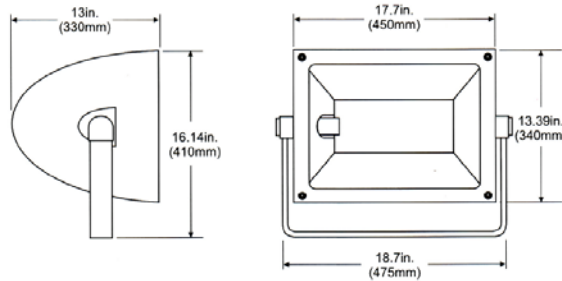

DIMENSIONS



Dimensions are subject to change. For critical applications, verify all dimensions with factory.



(Shown with Yoke Mount)

Die cast aluminum housing with integral hinging feature for ease of maintenance. Ideal for buildings, parks, signage, sports field, parking areas where general floodlighting is desired. Tempered glass maximum light distribution. Optional polycarbonate shield or wire guard for vandalproof protection is available. Anodized aluminum reflector designed in conjunction with diffuser for maximum efficiency. Heavy duty adjustable yoke for excellent aiming capabilities. Fully gasketed weather resistant construction. For wall or ceiling mounting. Designed for max of 400w metal halide or high-pressure sodium.

HOUSING

Rugged die cast aluminum housing.

ELECTRICAL

For metal halide lamping, ballast is high power factor, constant wattage auto transformer. Electrical components are mounted to cast aluminum housing for optimum heat dissipation. For high pressure sodium, ballast is normal power factor reactor type for 120V. High power factor, multi-tap, and most fixed voltages available.

SHIELDING

Tempered glass is standard.

FINISH

Baked on premium architectural bronze for maximum durability. Optional white or Custom Color.

CERTIFICATION

UL and CUL listed for Wet Locations.

ORDERING

<u>MODEL</u>	<u>WATTAGE</u>	<u>TYPE</u>	<u>VOLTAGE</u>
FLH	150	PSMH- Pulse Start Metal Halide	120
	250		277
	150	HPS- High Pressure Sodium	480
	250		MULTI
	400		

OPTIONS:

- SF** – Slip Fitter
- YK** – Yoke
- VS** – Vandal Shield
- WG** – Wire Guard
- TP** – Tamperproof hardware
- GLR** – Fusing
- CC** – Custom Color

JOB NAME:
FIXTURE TYPE:
MODEL NO:

