

# 1. Recessed

# Recessed Center Basket

# D/I-C

## DIMENSIONS

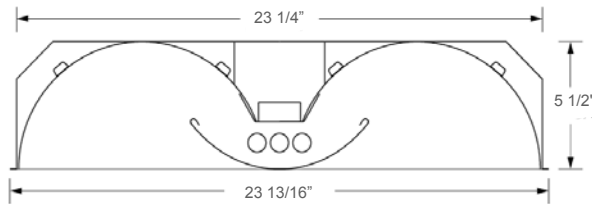

Dimensions are subject to change. For critical applications, verify all dimensions with factory.



## ORDERING

Provides direct-indirect, soft, uniform illumination. Curved perforated details combine recessed fixture advantages with efficient indirect shielding. Perforated center basket, backed with reflective white acrylic, controls glare and veiling reflections. Optional high efficiency frosted or opal acrylic diffuser available. Shielding is easily removed for re-lamping. Surface mount and flanged fixture available for drywall ceilings.

### HOUSING

Die formed heavy gauge steel housing unitized into one piece.

### ELECTRICAL

Energy saving electronic ballasts comply with Federal Energy Efficiency standards. Ballasts are <10% THD and include 5 year manufacturer's warranty.

### SHIELDING

Perforated diffuser element with matte white acrylic overlay is standard.

### FINISH

All metal parts pretreated with a phosphate bonding process. All visible parts are post-painted with an electrostatically applied high temperature high reflectance baked matte white enamel for superior quality and durability.

### CERTIFICATION

All units bear UL Label. Made in U.S.A. Suitable for damp locations. ARRA and BAA compliant.

MODEL	LAMP QTY	WATTAGE/TYPE	VOLTAGE
<b>D/I-22C</b> 2x2 unit	1	40BX	120
	2	50BX	277
		55BX	UNV
<b>D/I-24C</b> 2x4 unit	2	14T5	
	3	17T8	
		24T5HO	
<b>D/I-24C</b> 2x4 unit	2	9W LED	
	3	18W LED	
<b>D/I-24C</b> 2x4 unit	2	32T8	
	3	28T5	
		54T5HO	
<b>D/I-24C</b> 2x4 unit	4	40BX	
		50BX	
		55BX	
<b>D/I-24C</b> 2x4 unit	3	18w LED	

### OPTIONS:

- Prefix MD/I** – Flanged Unit
- Prefix SD/I** – Surface Mount Unit
- EM** – Emergency Battery Pack
- DM** – Dimming (Specify type)
- FA** – Frosted Acrylic Diffuser
- OA** – Opal Acrylic Diffuser
- 2CKT** – Two-circuit wiring
- HR** – Heat Removal Slots



JOB NAME:
FIXTURE TYPE
MODEL NO: